

OFS-mixing nozzle type FMD

high quality plastic parts require a thermally homogenous melt

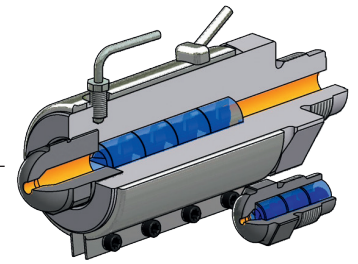

APPLICATION FIELDS:

For high quality plastic parts, it is necessary to have a thermal homogeneous melt. The regular homogeneity of additives like flame retardant and UV-stabilizer are also a guarantor for high quality plastic parts as colour and thermal mixing. The high blend power of the OFS-mixing-nozzle ensures saving of colour-batches and other additives.

STATIC WING-MIXER TYPE FM

The static wing-mixer consists of 4 rustproof elements with specifically arranged wings, in order to mix the cast. Each element is arranged in such a way that by combining several elements a complete mixing system develops. This system produces the desired homogeneity through continuous swirling of the fusion stream in layers, which are spread over the whole flow diameter.

YOUR BENEFIT:

1. thermally homogeneous melt.
2. uniform melt viscosity also with high regenerate portion.
3. closer tolerances, better surface quality of the shaped parts, that means less discarded parts.
4. homogeneous colour distribution → streak-free products, reduced colouring material costs.
5. amortization by production advantages within a short time.
6. self-cleaning, no dead corners.

PRODUCT FEATURES:

- ▶ 4 mixing elements.
- ▶ completely detachable → simple cleaning.
- ▶ high mechanical firmness through cast ring system.
- ▶ available for all machine types.
- ▶ suitable for nearly all plastic materials.
- ▶ nozzle complete with suitable heater and thermocouple

MORE OPTIONS:

- ▶ with shut-off function
- ▶ with filtration
- ▶ nozzlehead with dip nozzle
- ▶ nozzlebase with needle seat.

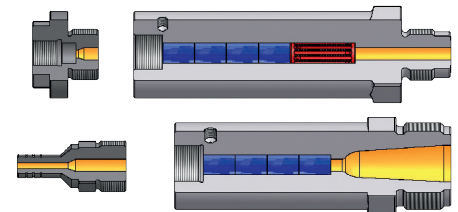

OFS-mixing nozzle type FMD optional with inner thread, filtration, shut-off function, needle seat and dip nozzle.

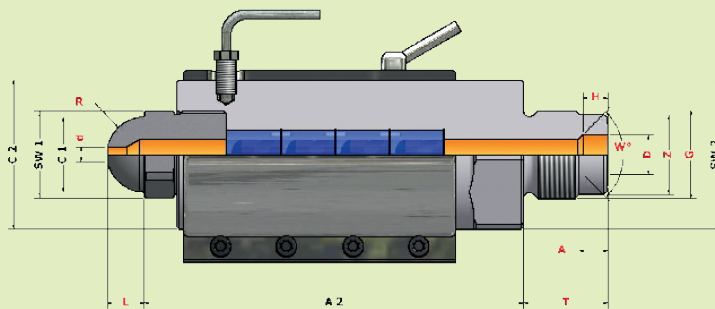

DATA AND DIMENSIONS (mm)

		FMD0/3	FMD0	FMDI	FMDII	FMDIII
appr. screw dia	mm	bis 35	bis 35	30-75	70-130	ab 120
max. injection pressure	bar	2.000	2.000	2.000	2.000	2.000
length	A2	54-96	122	128/148	148/168	215
nozzlehead dia	C1	-	24	30	30	30
nozzlebase dia	C2	-	45	60	60	60
hexagon nozzlehead	SW1	-	27	32	32	32
hexagon nozzlebase	SW2	-	46	60	60	60

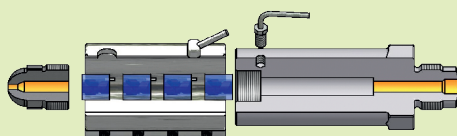

OFS-mixing nozzle type FMD „components“

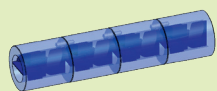

OFS-mixing insert type FM

REQUIRED MEASUREMENTS

machine thread	G	
T/A/D/Z/W°/H		specify if required
length of nozzlehead	L	
drill	d	
radius / surface	R	

REQUIRED PARAMETERS

material (MFI)		
shot weight	gr.	
melt temperature	°C	
injection time	sec	
Einspritzdruck spez.	bar	
injection pressure spec.		
screw dia	mm	